

**LEGENDA:**

- Poço de visita
- Boca de lobo
- Ramal para Boca de lobo Ø400
- Rede Pluvial Ø600, Ø800 e Ø1.000
- Dissipador de Energia

ESCALA 1/1000

**DETALHE BOCA DE LOBO**

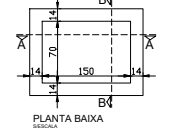

**DETALHE DISSIPADOR**

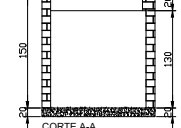

**DETALHE DISSIPADOR**

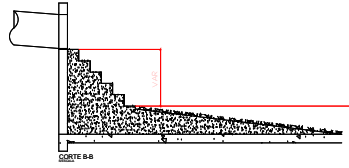

**DETALHE POÇO DE VISITA (1000mm)**

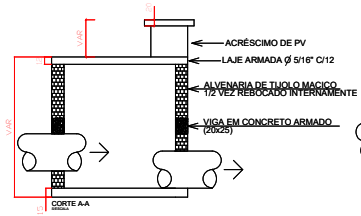

**DETALHE POÇO DE VISITA (600/800mm)**

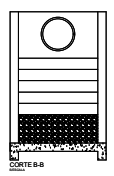
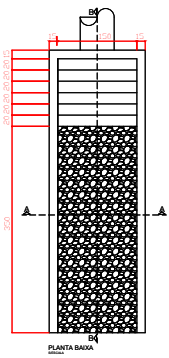
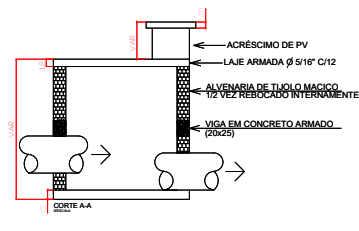

<b>GALERIAS PLUVIAIS</b>	
<b>SETOR SUL II</b> MUNICÍPIO DE CORUMBAIBA - ESTADO DE GOIÁS	
PROPRIEDADE DE: PREFEITURA MUNICIPAL DE CORUMBAIBA	
<b>LOCALIZAÇÃO</b> PERÍMETRO URBANO CONFRONTO COM O SETOR SUL I	<b>PROPRIETÁRIO:</b> PREFEITURA MUNICIPAL DE CORUMBAIBA CEP: 74.200-000-00
<b>COMPONENTE DE GALERIAS PLUVIAIS</b> ----- SETOR II	<b>AUTOR PROJETO:</b> ENG.º J. T. SILVA JUNIOR CREA: 10527/988-02
<b>APROVAÇÃO</b>	<b>FOLHA:</b> 1/1