

Detalhe - ISOMÉTRICO BANHEIRO
escala 1:25

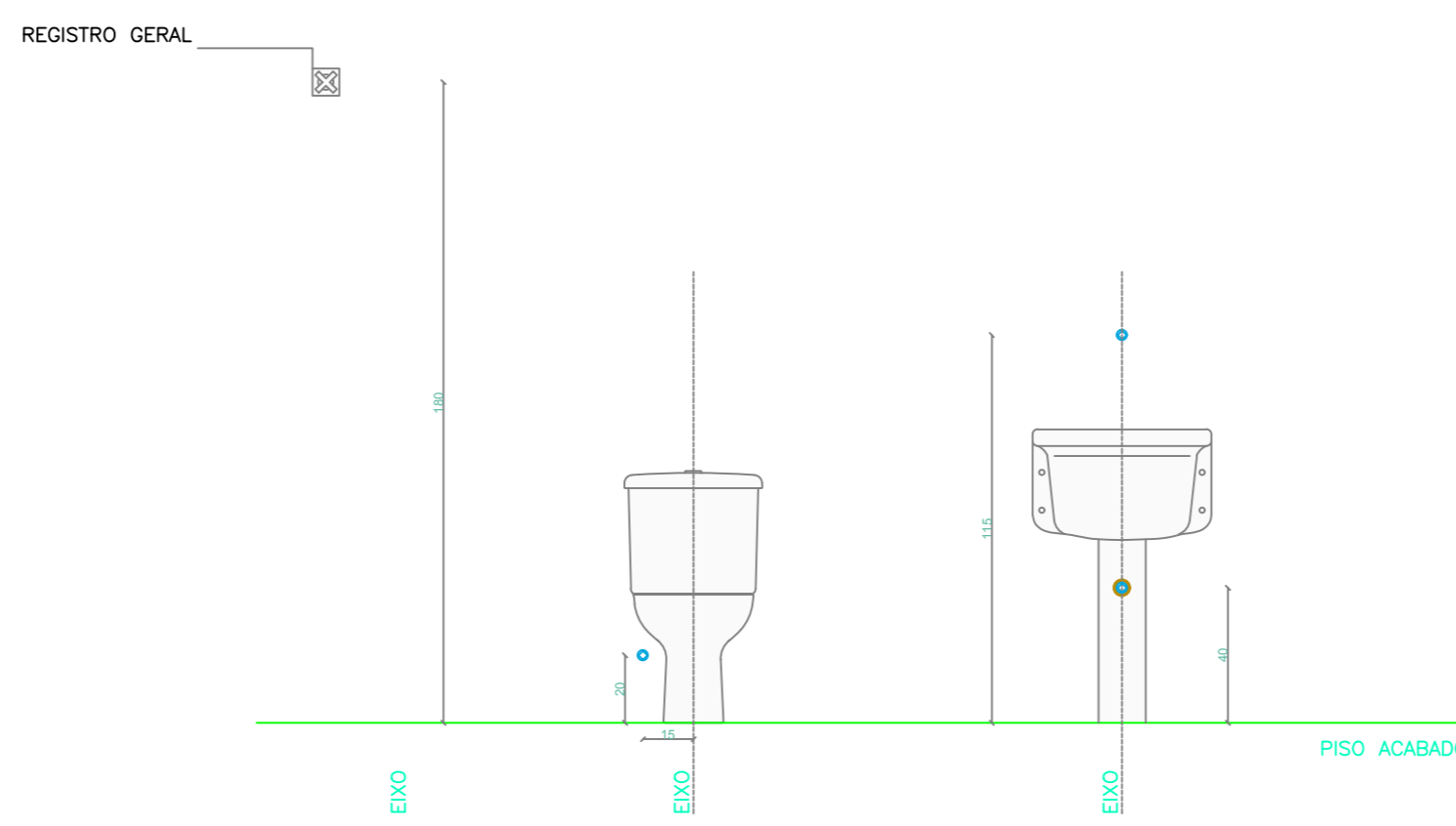

Detalhe - BANHEIROS
escala 1:25

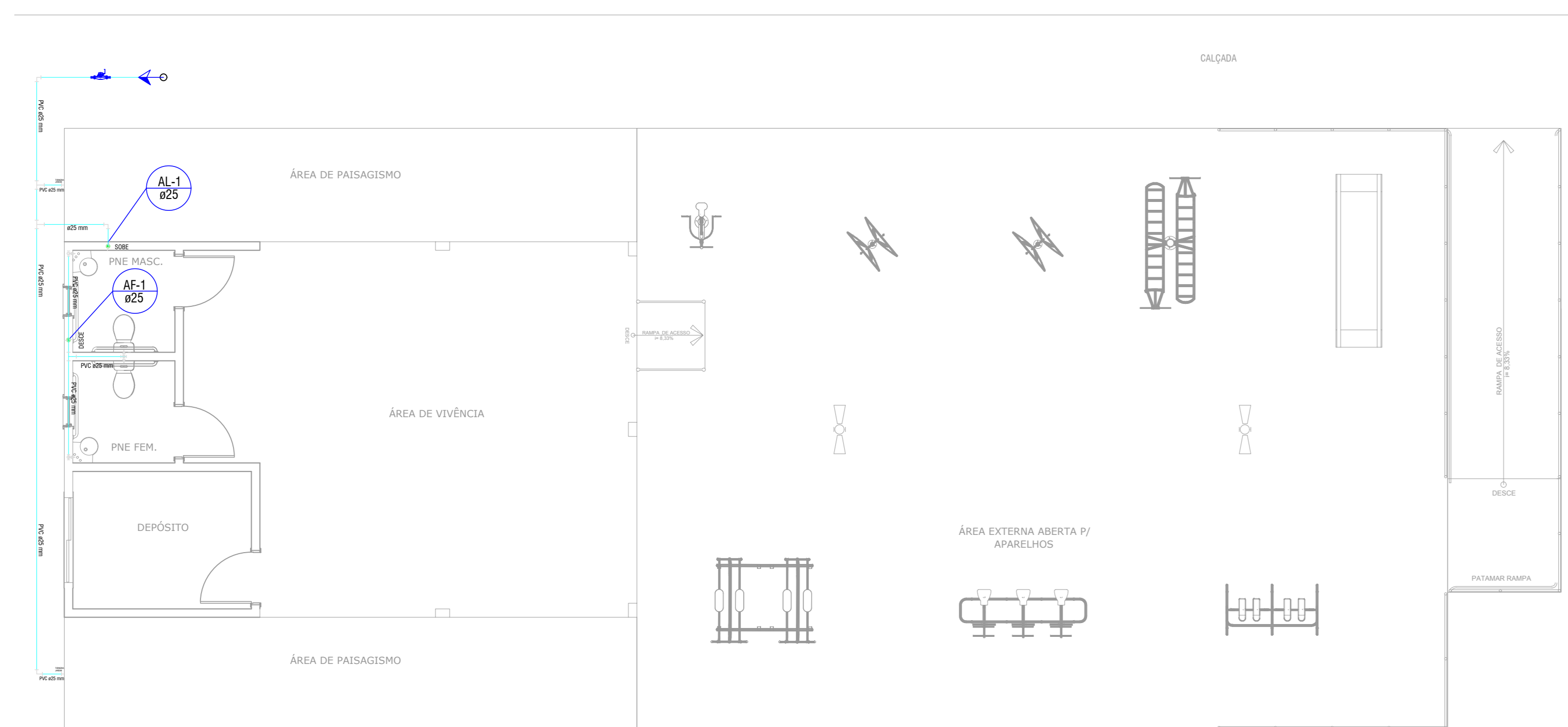
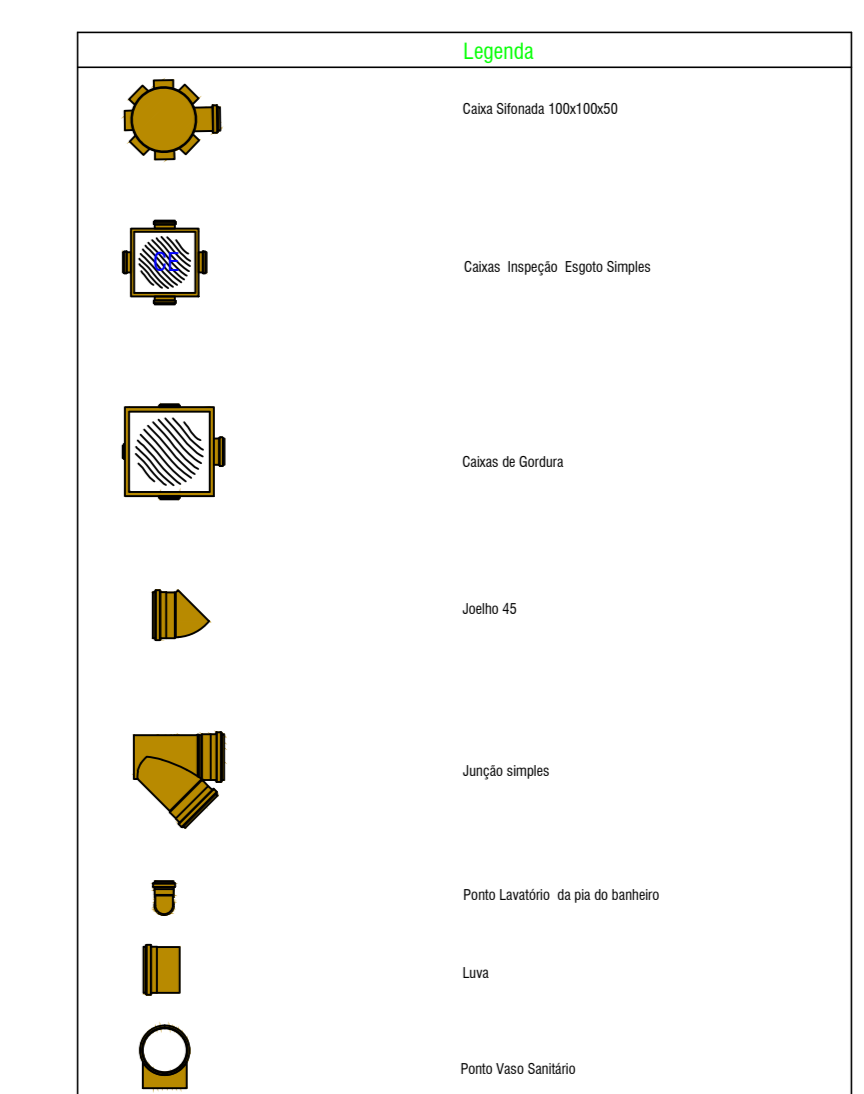
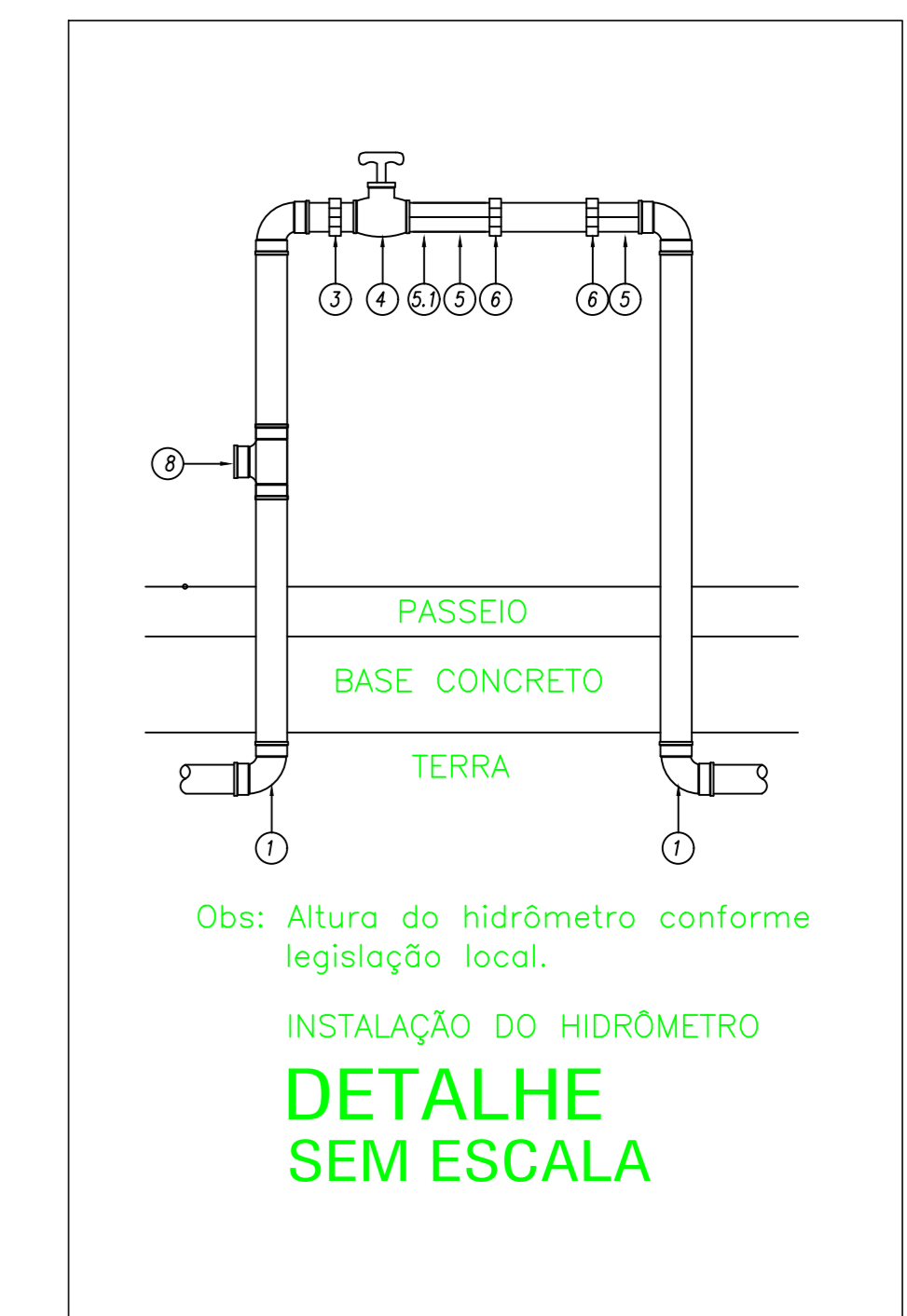
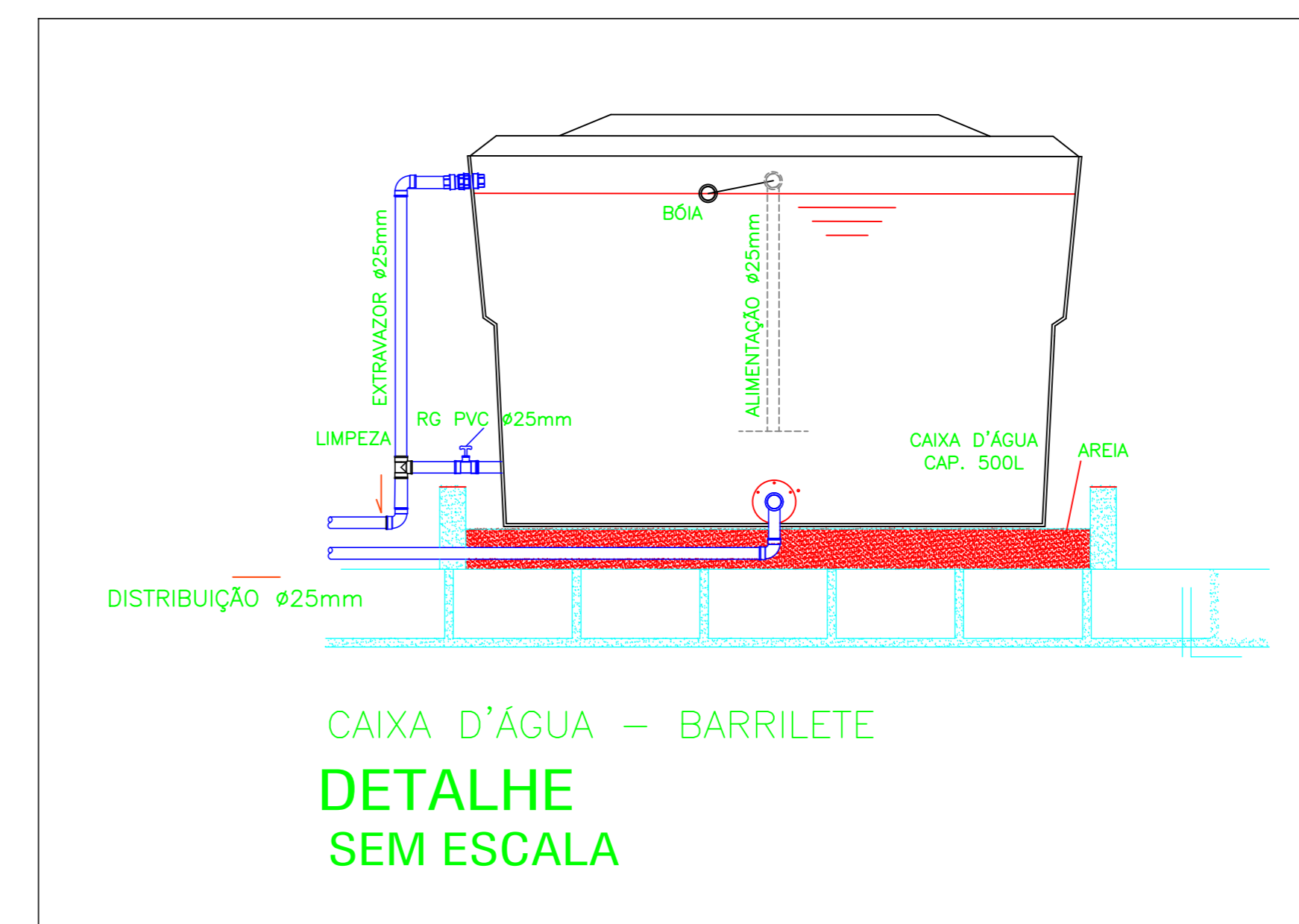

PLANTA BAIXA - IMPLANTAÇÃO GERAL ABASTECIMENTO DE ÁGUA
escala 1:75

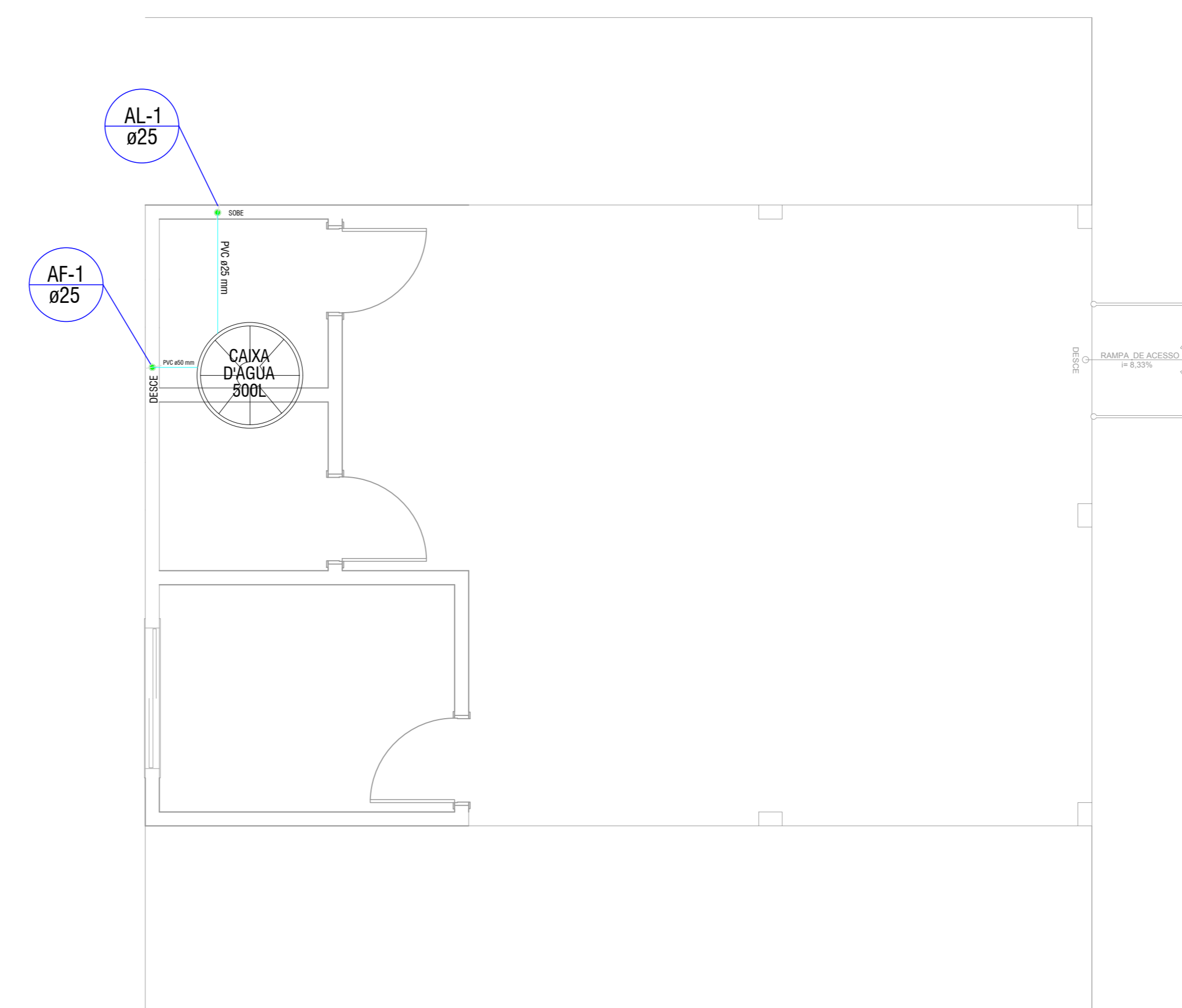

Detalhe - ALIMENTAÇÃO BARRILETE
escala 1:50

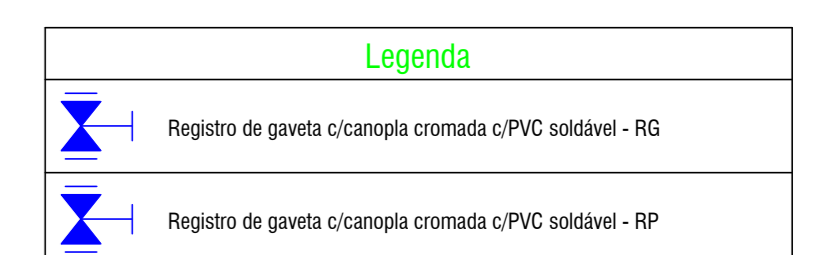
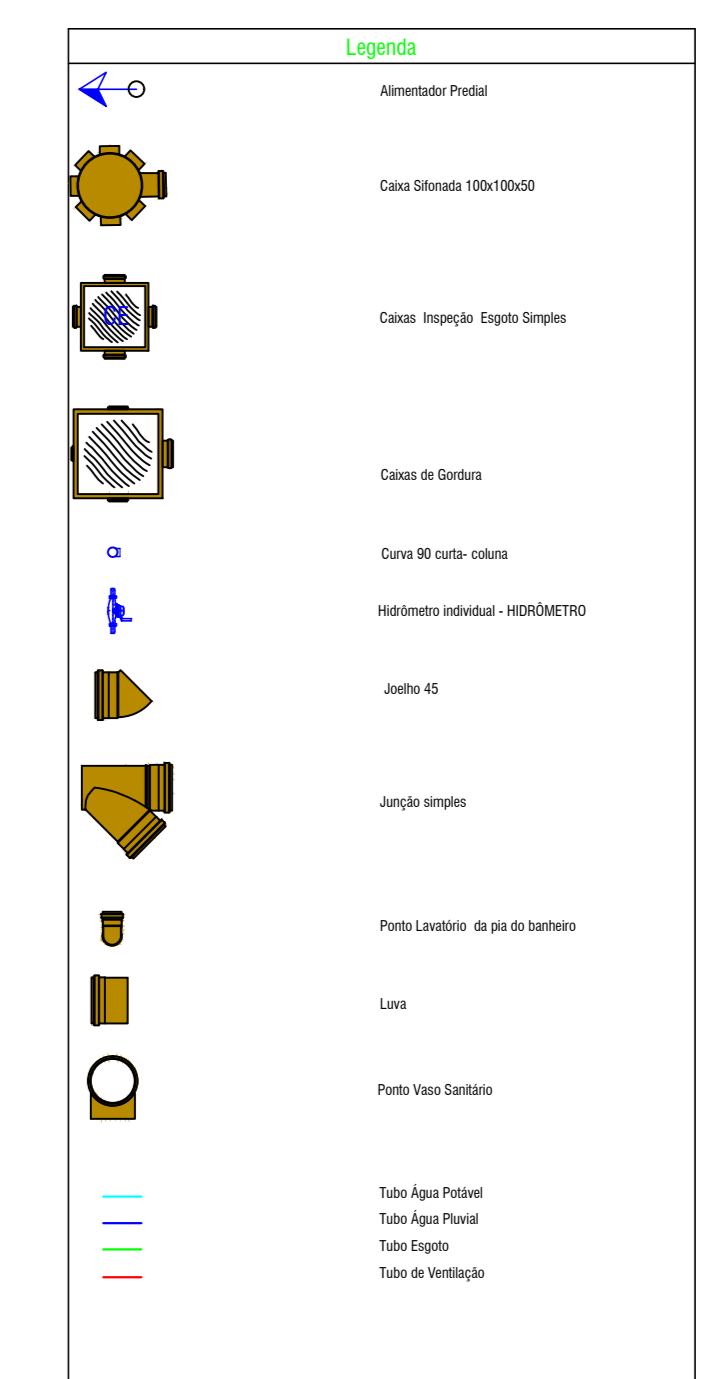

PROJETO HIDRO SANITÁRIO

| | |
|--|---|
| PROPRIETÁRIO: | PREFEITURA MUNICIPAL DE CORUMBABA |
| PROJETO / LOCAL: | Rua 04, Rua Dona Maria Lina Naves, QD 09 Setor Sul I |
| PROPRIETÁRIO: | FUNDO MUNICIPAL DE SAÚDE DE CORUMBABA CNPJ: 11.178.888.0001-27 |
| PROJETISTA: | RHACOLNY TEIXEIRA SANTOS CREA: 193507140-03 |
| PLANTA BAIXA E DETALHAMENTO DA REDE DE ABASTECIMENTO DE ÁGUA | |
| Desenho: Rhacolny | Revisão: 00 |
| Data: Março / 2023 | Escala: Indicada |
| FOLHA 02/02 | |

PREFEITURA MUNICIPAL DE CORUMBABA - GO
 Rua 31ª km 01 - CEP: 76.612-000 - Corumbá, Mato Grosso do Sul
 Fone/Fax: (67) 3447-11000